

Galaxy Tie-Dye Technique

Combine bleach and colour applications on a spiral twist for a tie-dye look that's out of this world! Learn how here!





Step 1:

Pinch shirt in centre of fabric where you would like the centre of the galaxy design to be.
Twist fabric into a spiral shape.

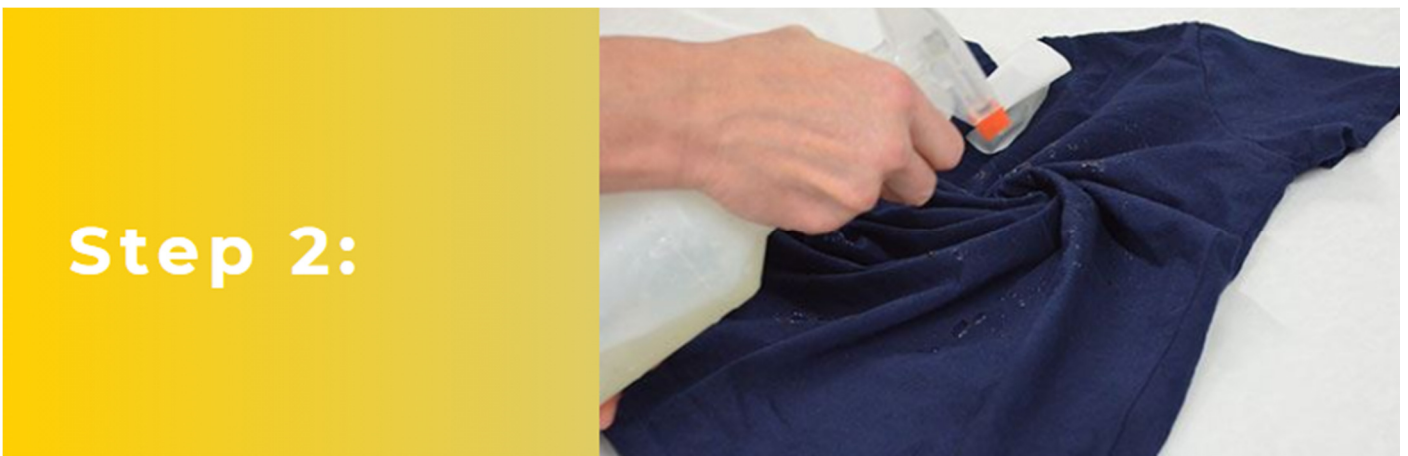

Step 2:

Mix bleach and water in a spray bottle (50/50 solution) and spray desired amount over twisted shirt.



Step 3:

Untwist shirt and monitor periodically as the colour bleaches.

Step 4:



Once shirt has bleached to desired liking, thoroughly rinse bleach from shirt.

Step 5:



Spray a rainbow of One-Step Dye colours onto shirt. Let set, then launder according to dye instructions.